

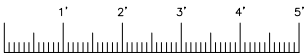

705 13TH STREET, LAKE PARK, FL
800-848-6652

Riley County Police Department
Manhattan, Kansas

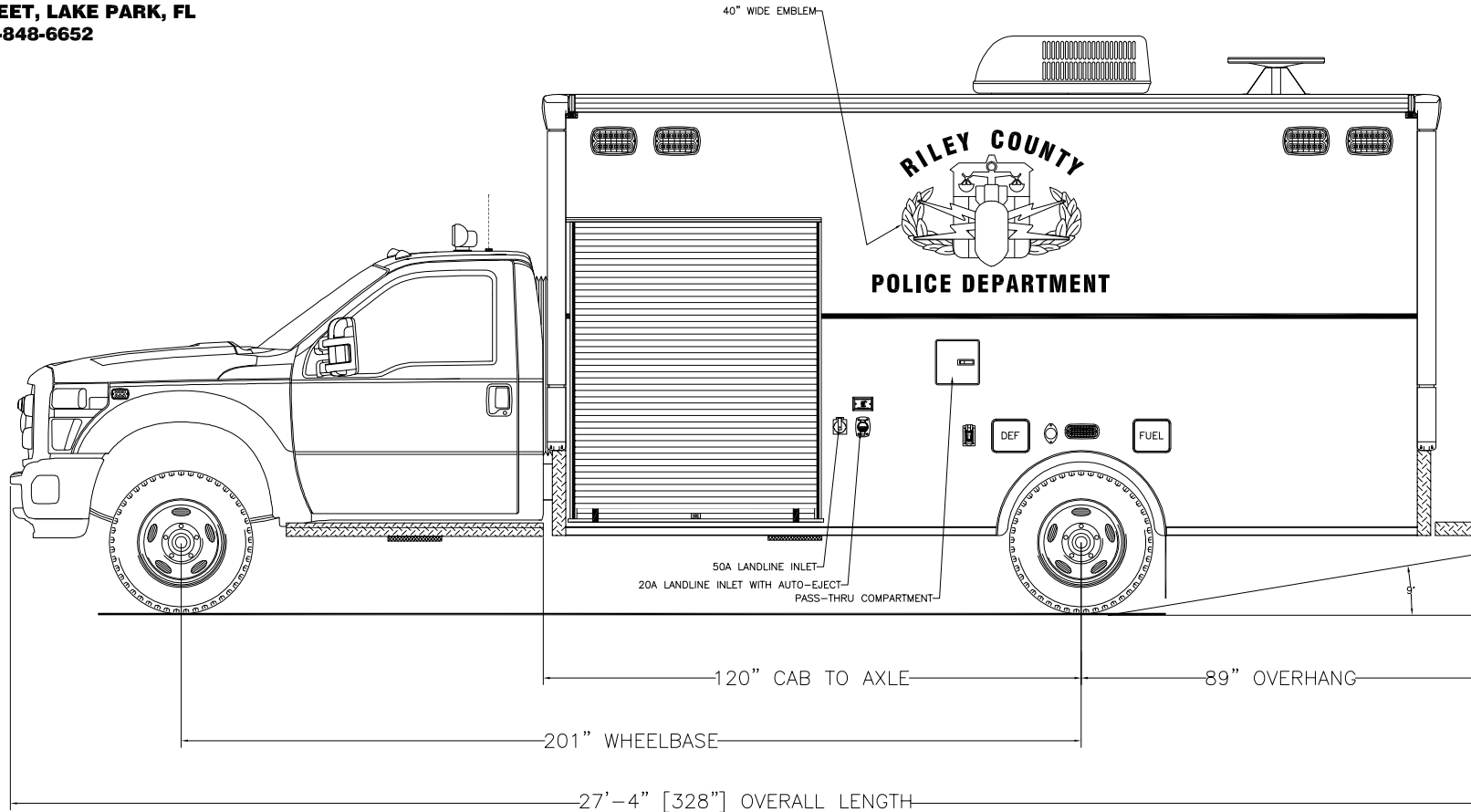

Streetside Overall

THESE DESIGN/ENGINEERING DRAWING(S) ARE THE PROPERTY OF EMERGENCY VEHICLES, INC. THEY ARE PROPRIETARY, AND ARE FOR THE EXCLUSIVE USE OF YOUR ENTITY. ANY DIVULGING OF THIS DATA TO A THIRD PARTY IS PROHIBITED.

<i>EJanner</i> DATE: 01/14/16	
REVISION 1	NS - 01/26/16
REVISION 2	NS - 08/25/16
REVISION 3	-
REVISION 4	-
REVISION 5	-



705 13TH STREET, LAKE PARK, FL
800-848-6652

Riley County Police Department Manhattan, Kansas

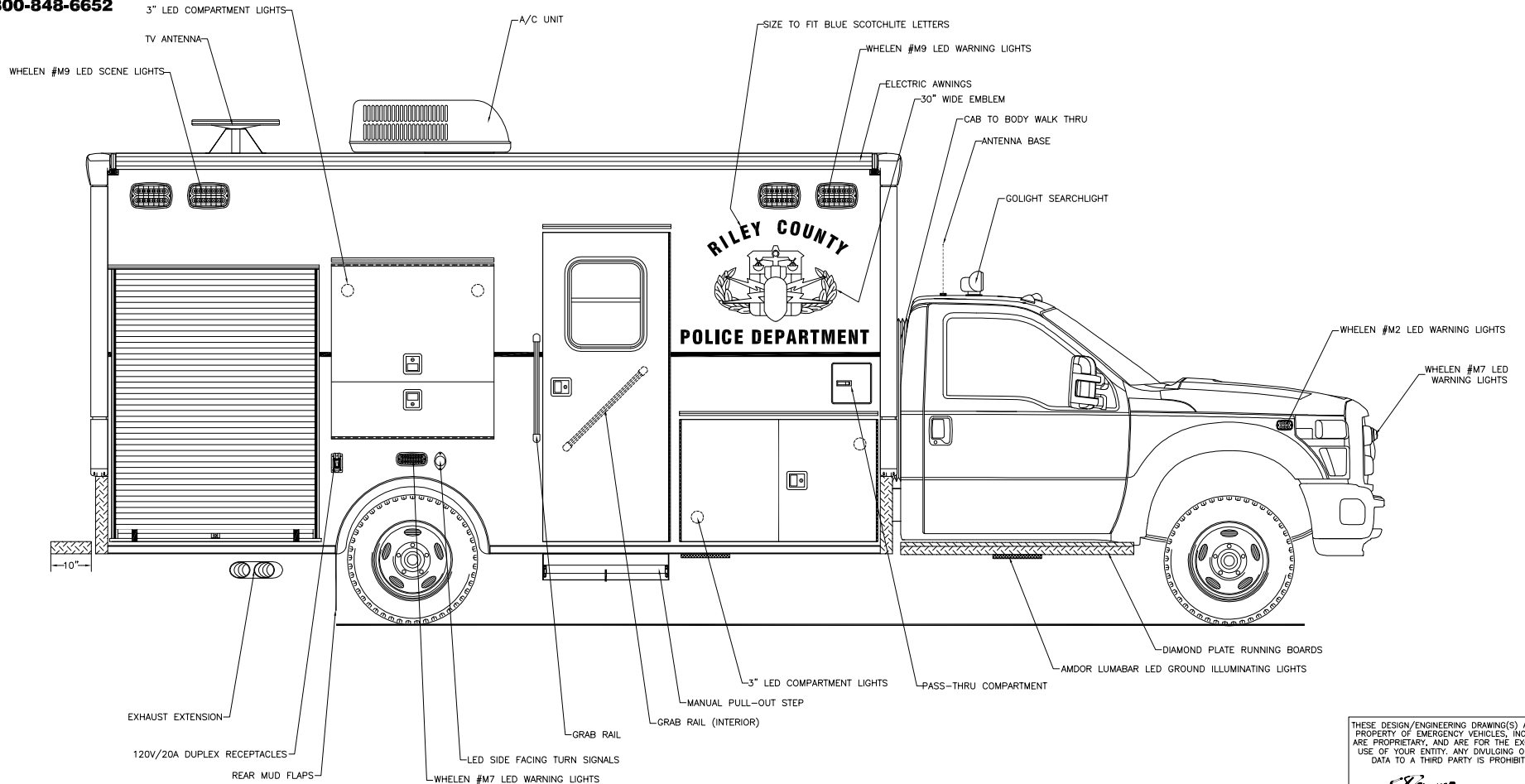

THESE DESIGN/ENGINEERING DRAWING(S) ARE THE PROPERTY OF EMERGENCY VEHICLES, INC. THEY ARE PROPRIETARY, AND ARE FOR THE EXCLUSIVE USE OF YOUR ENTITY. ANY DIVULGING OF THIS DATA TO A THIRD PARTY IS PROHIBITED.

<i>E.V.I.</i> DATE: 01/14/16	
REVISION 1	NS - 01/26/16
REVISION 2	NS - 08/25/16
REVISION 3	-
REVISION 4	-
REVISION 5	-

Curbside Overall



705 13TH STREET, LAKE PARK, FL
800-848-6652

Riley County Police Department Manhattan, Kansas

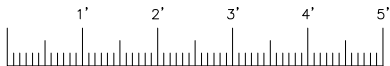
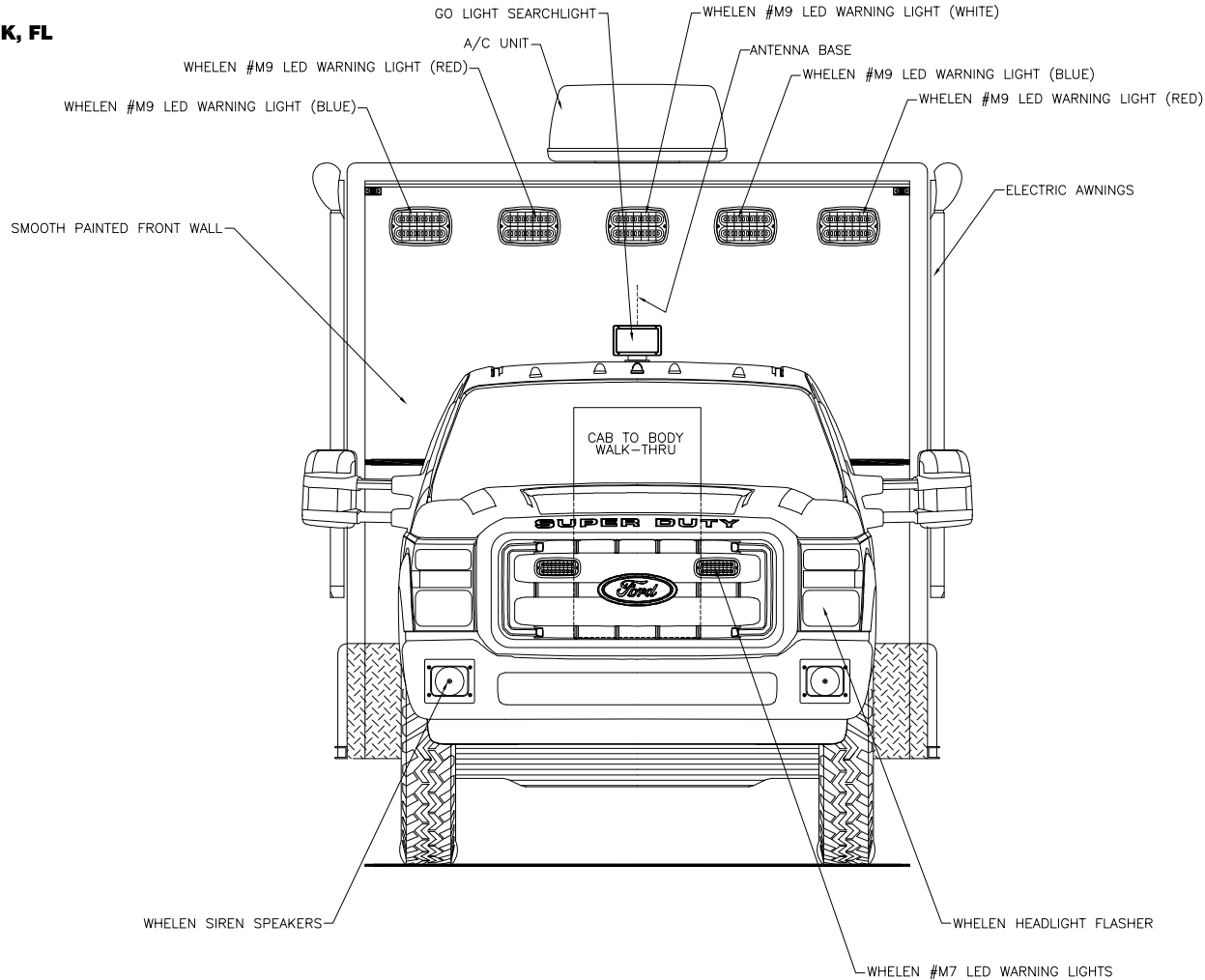

Front View

THESE DESIGN/ENGINEERING DRAWING(S) ARE THE PROPERTY OF EMERGENCY VEHICLES, INC. THEY ARE PROPRIETARY, AND ARE FOR THE EXCLUSIVE USE OF YOUR ENTITY. ANY DIVULGING OF THIS DATA TO A THIRD PARTY IS PROHIBITED.

E. J. ... DATE: 01/14/16

REVISION 1	NS - 01/26/16
REVISION 2	-
REVISION 3	-
REVISION 4	-
REVISION 5	-



705 13TH STREET, LAKE PARK, FL
800-848-6652

Riley County Police Department Manhattan, Kansas

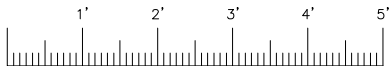
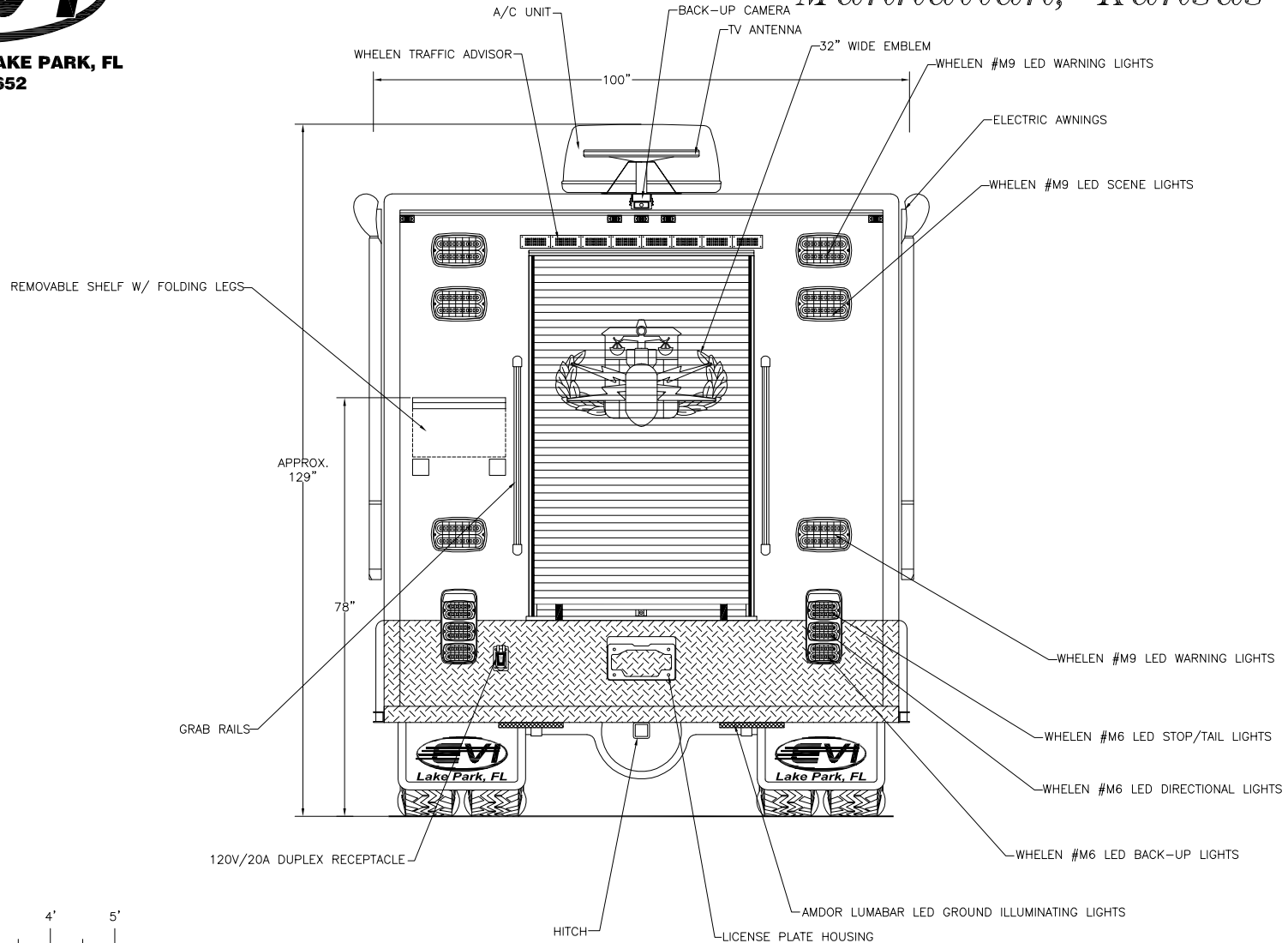

Rear View

THESE DESIGN/ENGINEERING DRAWING(S) ARE THE PROPERTY OF EMERGENCY VEHICLES, INC. THEY ARE PROPRIETARY, AND ARE FOR THE EXCLUSIVE USE OF YOUR ENTITY. ANY DIVULGING OF THIS DATA TO A THIRD PARTY IS PROHIBITED.

<i>E.V.anner</i> DATE: 01/14/16	
REVISION 1	NS - 01/26/16
REVISION 2	NS - 08/25/16
REVISION 3	-
REVISION 4	-
REVISION 5	-



705 13TH STREET, LAKE PARK, FL
800-848-6652

Riley County Police Department
Manhattan, Kansas

COAT RAIL WITH (2)
HEAVY DUTY HANGERS

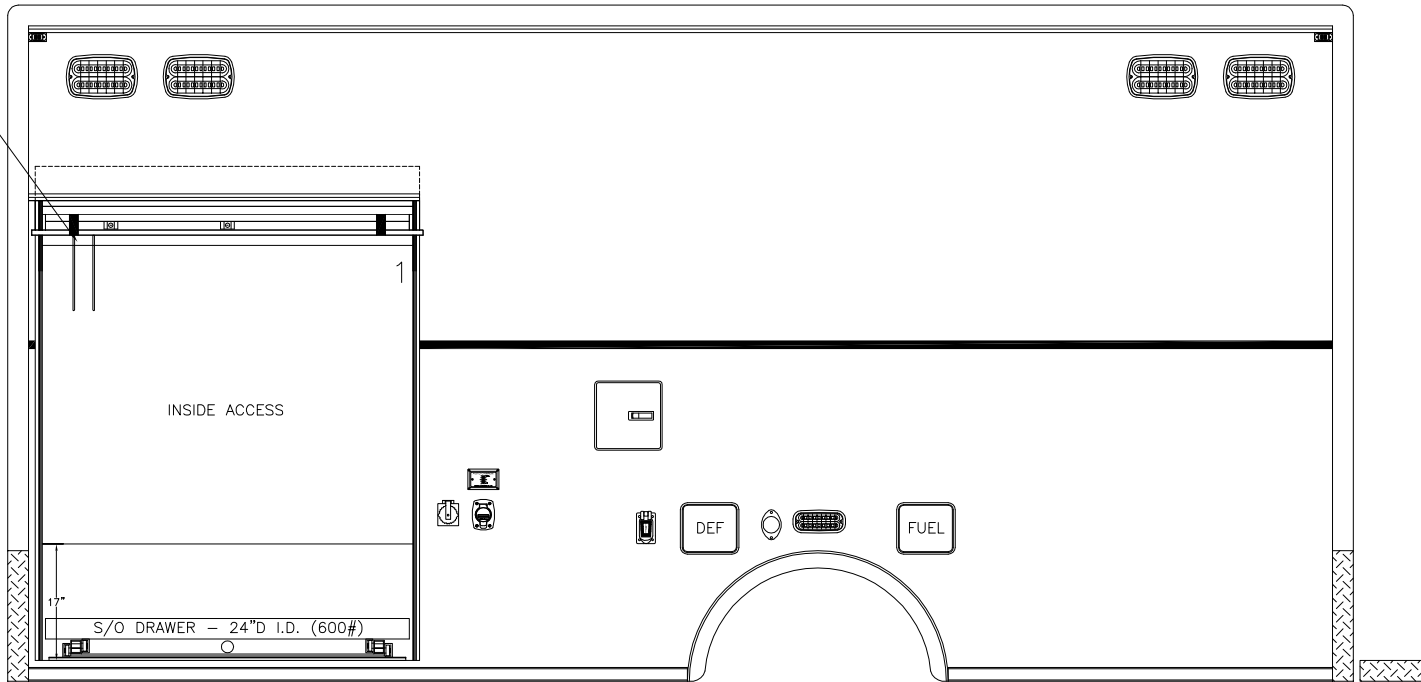

← FRONT

COMPARTMENT LEGEND
COMPT. #1 - 56"W X 72"H X 25"D

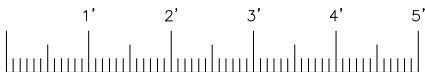

Streetside Body

THESE DESIGN/ENGINEERING DRAWING(S) ARE THE PROPERTY OF EMERGENCY VEHICLES, INC. THEY ARE PROPRIETARY, AND ARE FOR THE EXCLUSIVE USE OF YOUR ENTITY. ANY DIVULGING OF THIS DATA TO A THIRD PARTY IS PROHIBITED.

E. J. [Signature] DATE: 01/14/16

REVISION 1	NS - 01/26/16
REVISION 2	-
REVISION 3	-
REVISION 4	-
REVISION 5	-



705 13TH STREET, LAKE PARK, FL
800-848-6652

Riley County Police Department Manhattan, Kansas

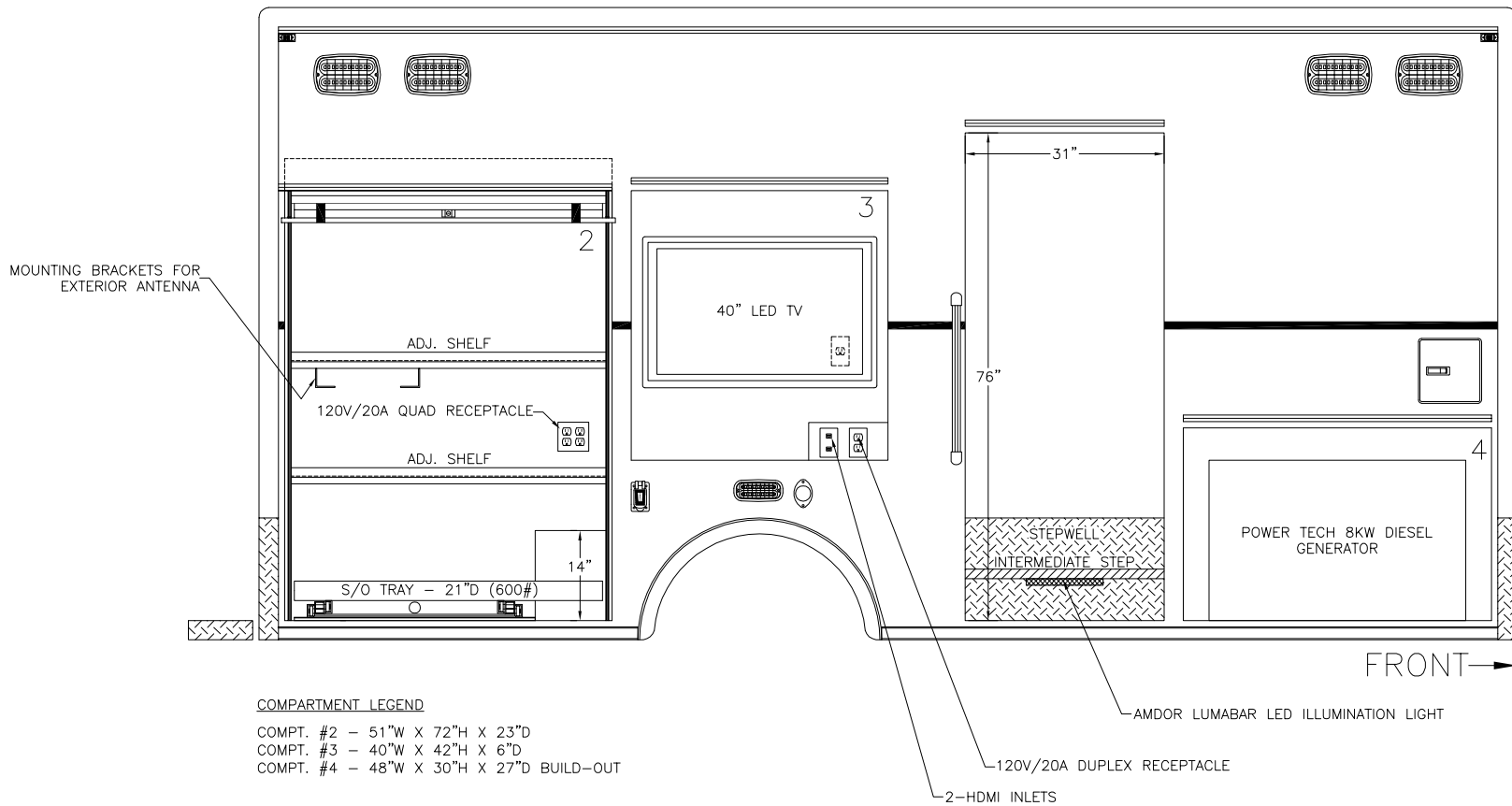

COMPARTMENT LEGEND

- COMPT. #2 - 51"W X 72"H X 23"D
- COMPT. #3 - 40"W X 42"H X 6"D
- COMPT. #4 - 48"W X 30"H X 27"D BUILD-OUT

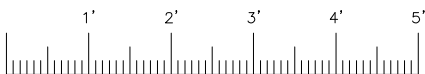

Curbside Body

THESE DESIGN/ENGINEERING DRAWING(S) ARE THE PROPERTY OF EMERGENCY VEHICLES, INC. THEY ARE PROPRIETARY, AND ARE FOR THE EXCLUSIVE USE OF YOUR ENTITY. ANY DIVULGING OF THIS DATA TO A THIRD PARTY IS PROHIBITED.

<i>E. J. [Signature]</i> DATE: 01/14/16	
REVISION 1	NS - 01/26/16
REVISION 2	-
REVISION 3	-
REVISION 4	-
REVISION 5	-



705 13TH STREET, LAKE PARK, FL
800-848-6652

Riley County Police Department Manhattan, Kansas

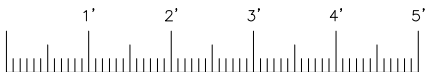
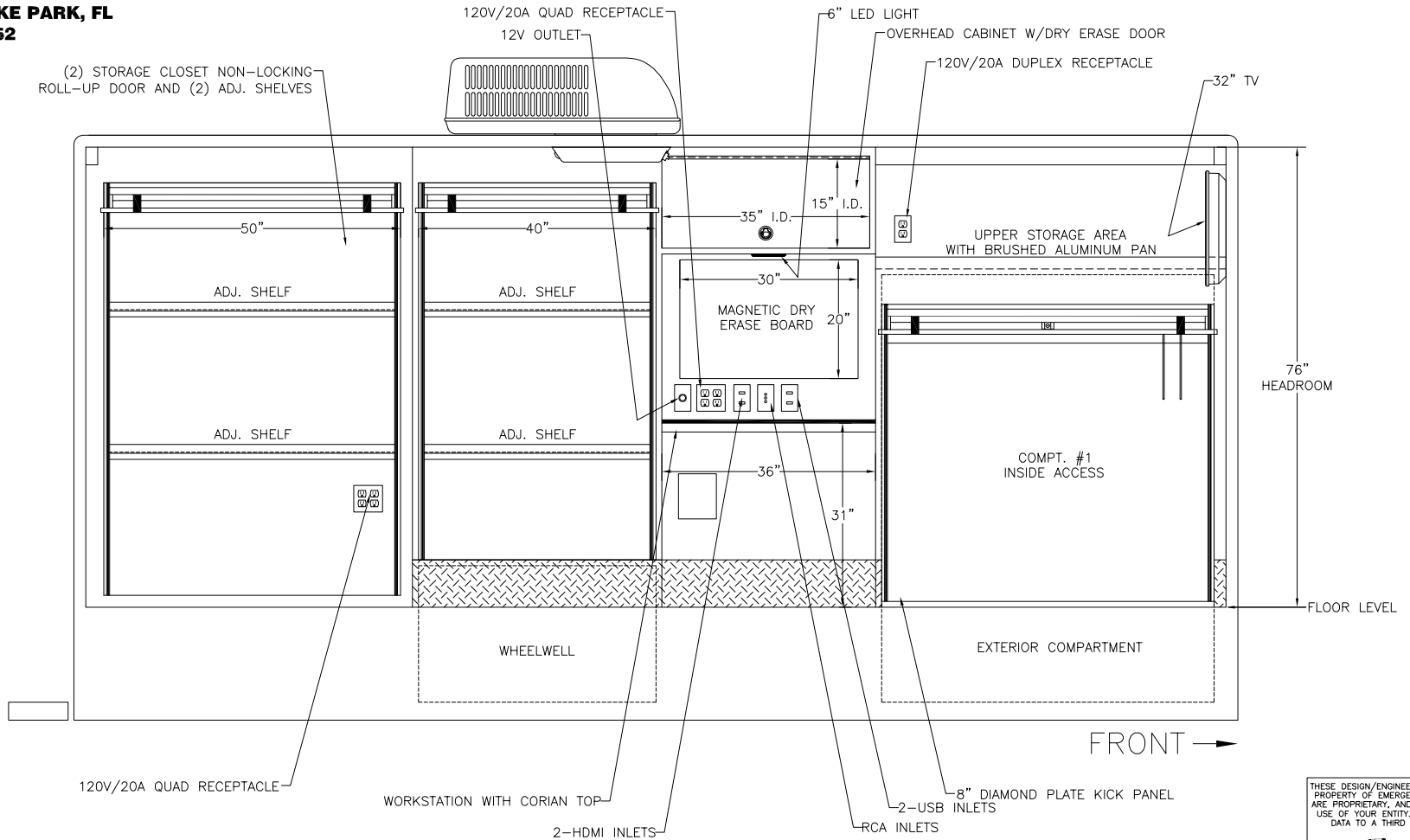

Streetside Interior

THESE DESIGN/ENGINEERING DRAWING(S) ARE THE PROPERTY OF EMERGENCY VEHICLES, INC. THEY ARE PROPRIETARY, AND ARE FOR THE EXCLUSIVE USE OF YOUR ENTITY. ANY DIVULGING OF THIS DATA TO A THIRD PARTY IS PROHIBITED.

E.V. Inc. DATE: 01/14/16

REVISION 1	NS - 01/26/16
REVISION 2	-
REVISION 3	-
REVISION 4	-
REVISION 5	-



705 13TH STREET, LAKE PARK, FL
800-848-6652

Riley County Police Department Manhattan, Kansas

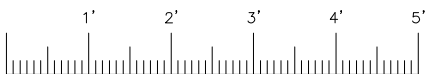
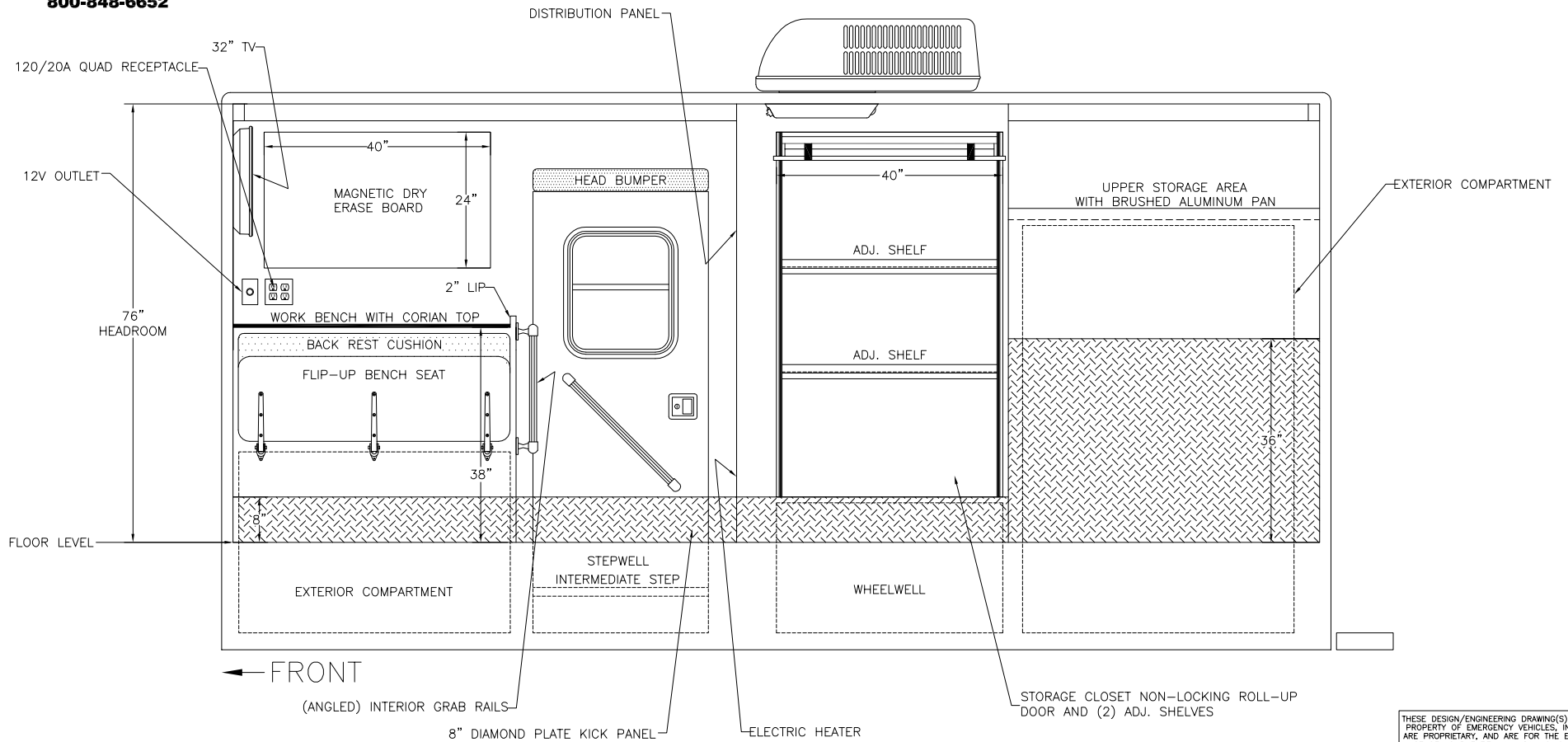

Curbside Interior

THESE DESIGN/ENGINEERING DRAWING(S) ARE THE PROPERTY OF EMERGENCY VEHICLES, INC. THEY ARE PROPRIETARY, AND ARE FOR THE EXCLUSIVE USE OF YOUR ENTITY. ANY DIVULGING OF THIS DATA TO A THIRD PARTY IS PROHIBITED.

<i>E.V.I.</i> DATE: 01/14/16	
REVISION 1	NS - 01/26/16
REVISION 2	-
REVISION 3	-
REVISION 4	-
REVISION 5	-



705 13TH STREET, LAKE PARK, FL
800-848-6652

Riley County Police Department Manhattan, Kansas

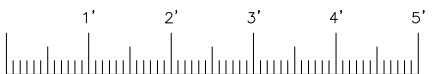
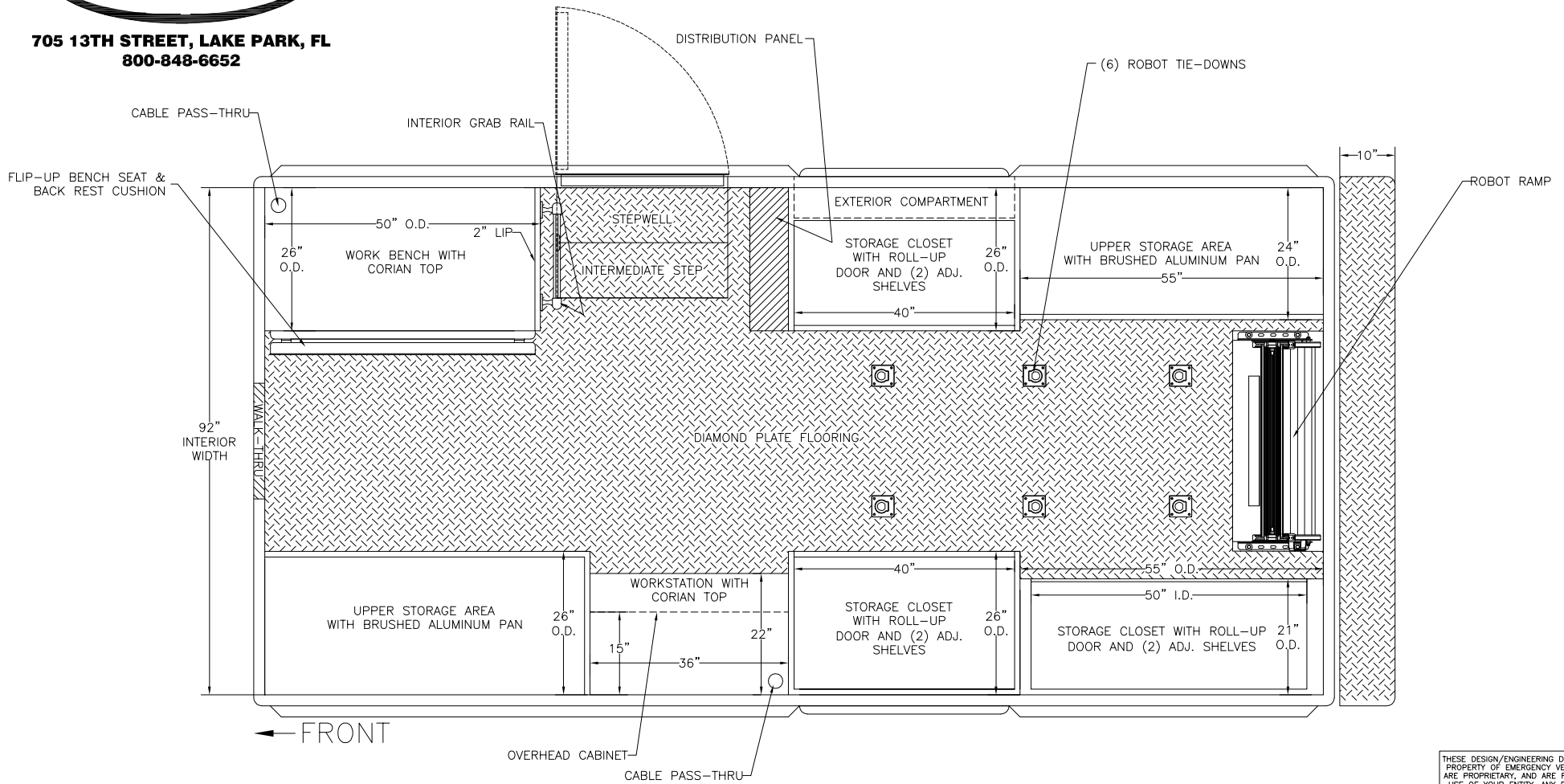

Body Planview

THESE DESIGN/ENGINEERING DRAWING(S) ARE THE PROPERTY OF EMERGENCY VEHICLES, INC. THEY ARE PROPRIETARY, AND ARE FOR THE EXCLUSIVE USE OF YOUR ENTITY. ANY DIVULGING OF THIS DATA TO A THIRD PARTY IS PROHIBITED.

<i>E. J. ...</i> DATE: 01/14/16	
REVISION 1	NS - 01/26/16
REVISION 2	-
REVISION 3	-
REVISION 4	-
REVISION 5	-