

**EMERGENCY VEHICLES, INC.**

*Cambria County EMA  
Cambria County, Pennsylvania*

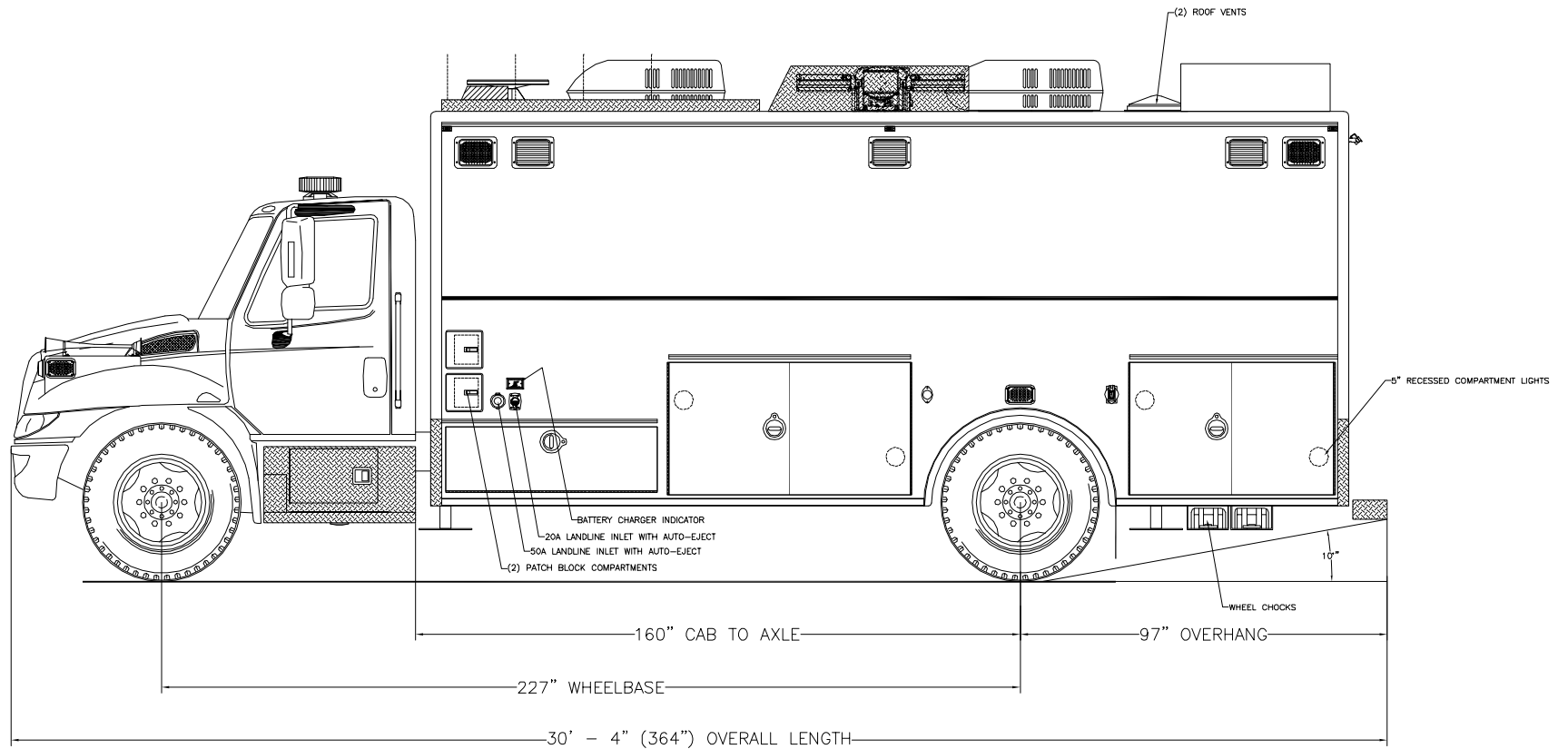

THESE DESIGN/ENGINEERING DRAWING(S) ARE THE PROPERTY OF EMERGENCY VEHICLES, INC. THEY ARE PROPRIETARY AND ARE FOR THE EXCLUSIVE USE OF YOUR ENTITY. ANY DIVULGING OF THIS DATA TO A THIRD PARTY IS PROHIBITED.

		DATE: 01/29/08
REVISION 1	NS	05/07/08
REVISION 2	NS	08/21/08
REVISION 3	-	-
REVISION 4	-	-
REVISION 5	-	-

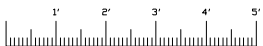

*Streetside Overall*

**EMERGENCY VEHICLES, INC.**

*Cambria County EMA  
Cambria County, Pennsylvania*

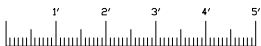
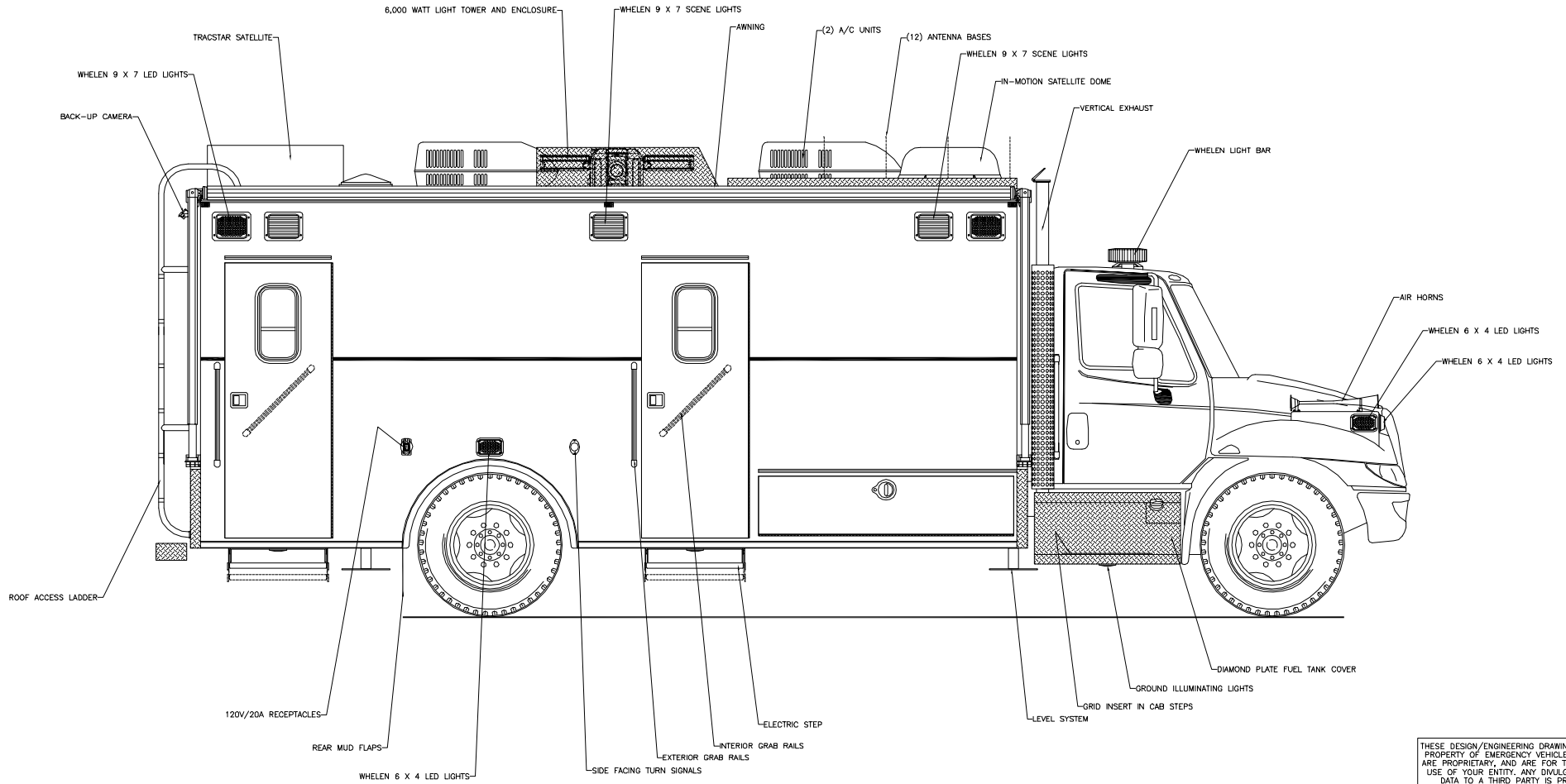

*Curbside Overall*

THESE DESIGN/ENGINEERING DRAWING(S) ARE THE PROPERTY OF EMERGENCY VEHICLES, INC. THEY ARE PROPRIETARY, AND ARE FOR THE EXCLUSIVE USE OF YOUR ENTITY. ANY DIVULGING OF THIS DATA TO A THIRD PARTY IS PROHIBITED.

		DATE: 01/29/08
REVISION 1	NS	05/07/08
REVISION 2	NS	08/21/08
REVISION 3	NS	08/26/08
REVISION 4	-	-
REVISION 5	-	-

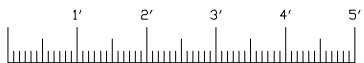
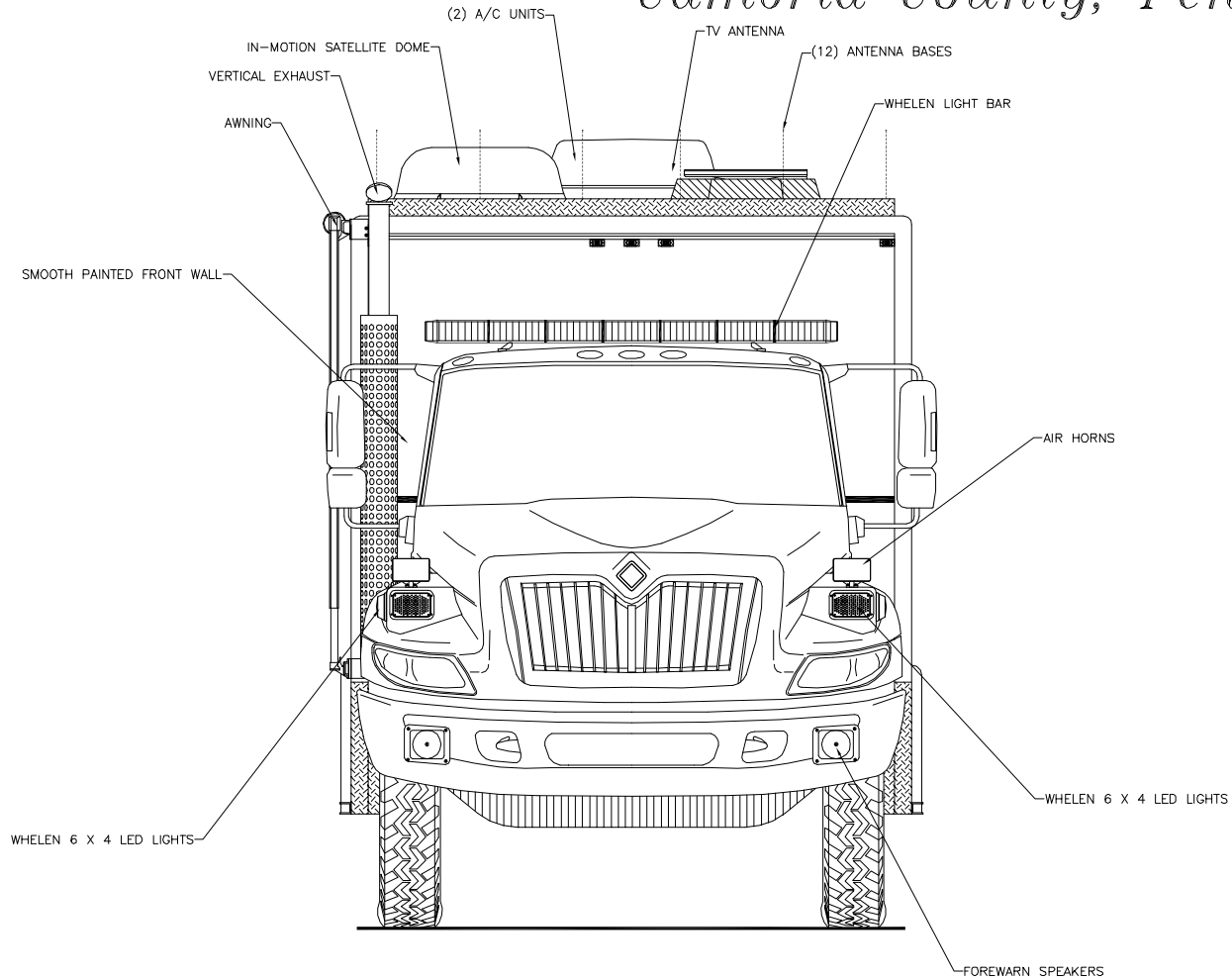

*Front View*

THESE DESIGN/ENGINEERING DRAWING(S) ARE THE PROPERTY OF EMERGENCY VEHICLES, INC. THEY ARE PROPRIETARY, AND ARE FOR THE EXCLUSIVE USE OF YOUR ENTITY. ANY DVULGING OF THIS DATA TO A THIRD PARTY IS PROHIBITED.

		DATE: 01/29/08
REVISION 1	NS	05/07/08
REVISION 2	NS	08/21/08
REVISION 3	NS	08/26/08
REVISION 4	-	-
REVISION 5	-	-

*Cambria County EMA  
Cambria County, Pennsylvania*

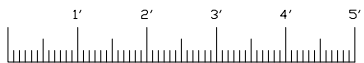
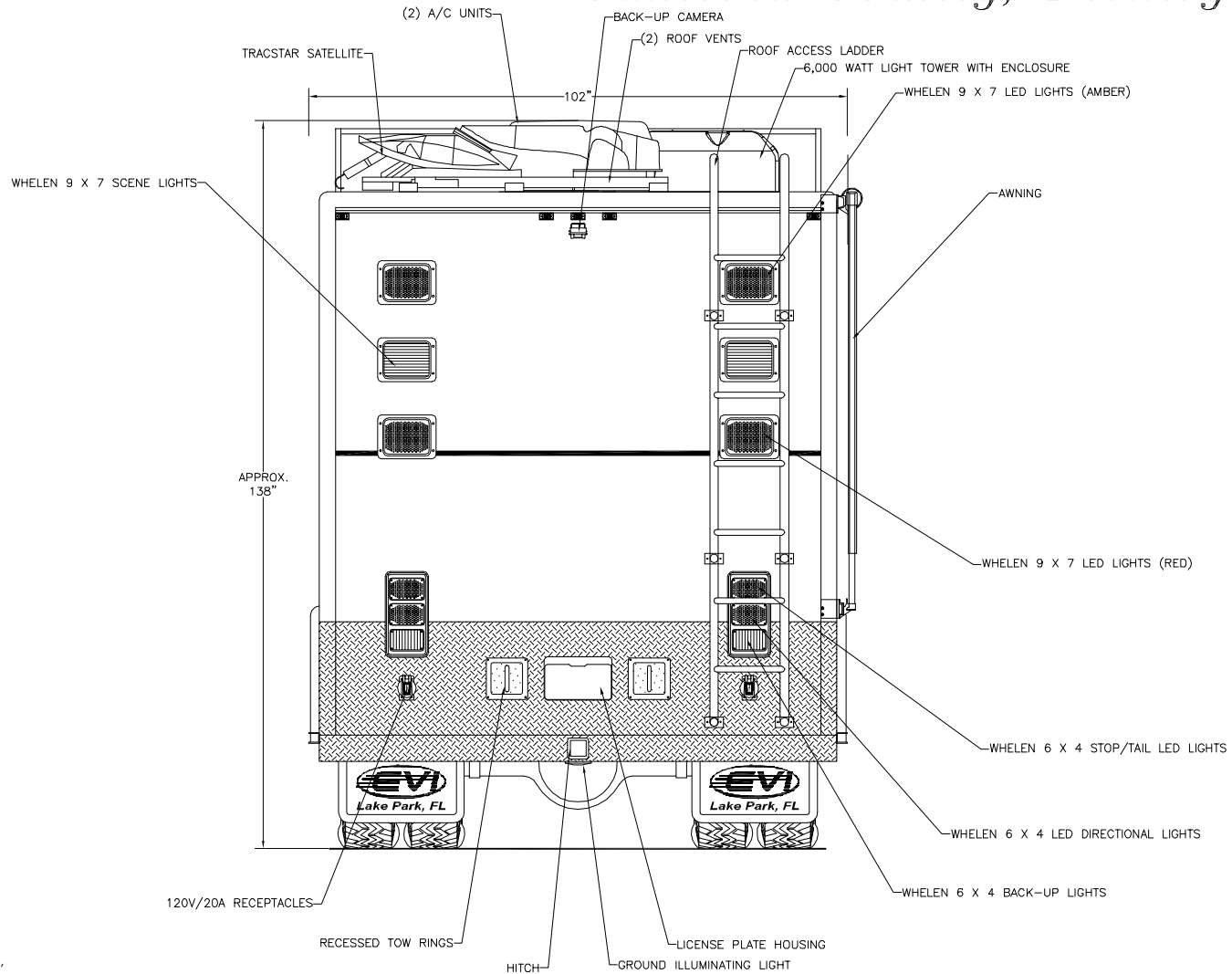

*Rear View*

THESE DESIGN/ENGINEERING DRAWING(S) ARE THE PROPERTY OF EMERGENCY VEHICLES, INC. THEY ARE PROPRIETARY, AND ARE FOR THE EXCLUSIVE USE OF YOUR ENTITY. ANY DIVULGING OF THIS DATA TO A THIRD PARTY IS PROHIBITED.

		DATE: 01/29/08
REVISION 1	NS	05/07/08
REVISION 2	NS	08/21/08
REVISION 3	NS	08/26/08
REVISION 4	-	-
REVISION 5	-	-

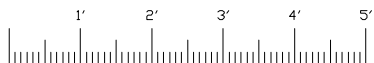
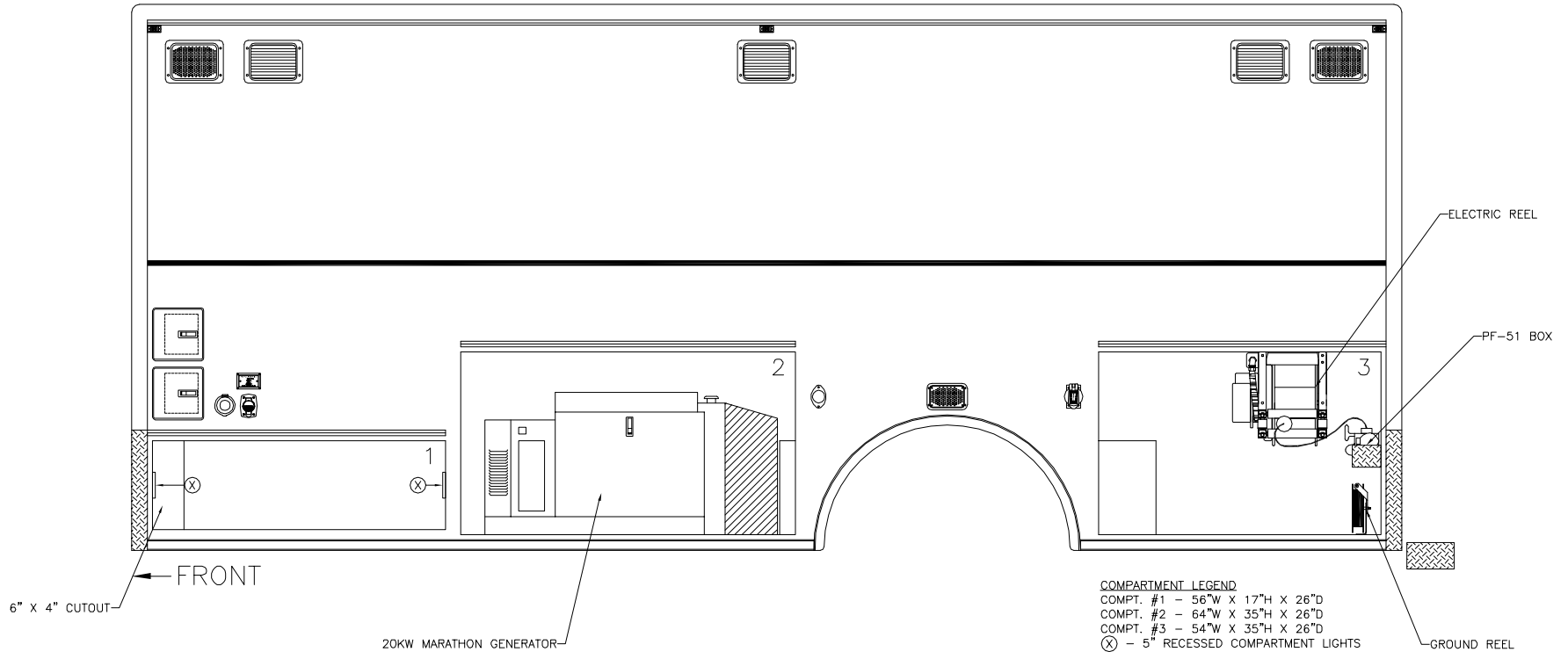

*Streetside Body*

THESE DESIGN/ENGINEERING DRAWING(S) ARE THE PROPERTY OF EMERGENCY VEHICLES, INC. THEY ARE PROPRIETARY, AND ARE FOR THE EXCLUSIVE USE OF YOUR ENTITY. ANY DVULGING OF THIS DATA TO A THIRD PARTY IS PROHIBITED.

		DATE: 01/29/08
REVISION 1	NS	05/07/08
REVISION 2	NS	08/21/08
REVISION 3	-	-
REVISION 4	-	-
REVISION 5	-	-

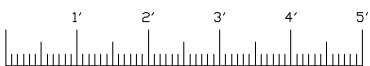
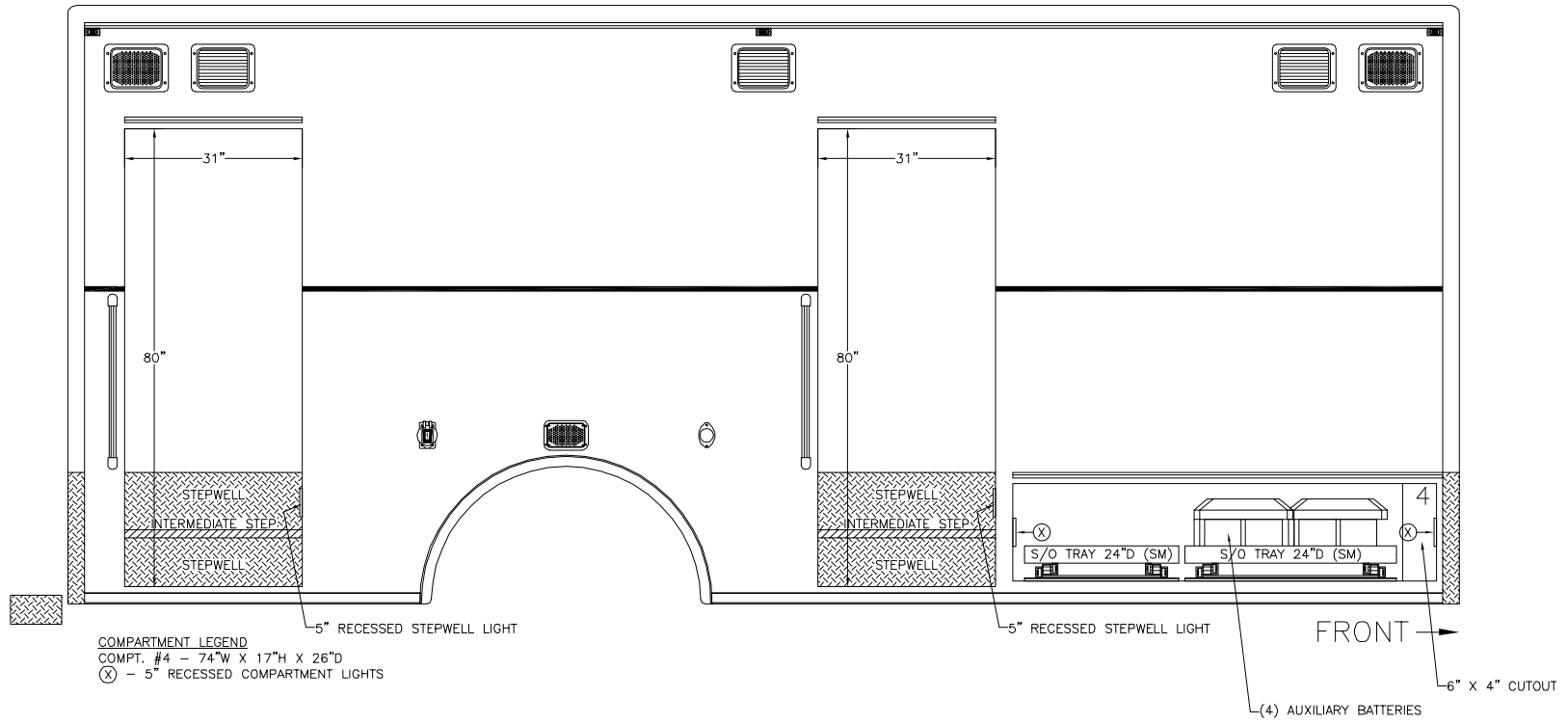

*Curbside Body*

THESE DESIGN/ENGINEERING DRAWING(S) ARE THE PROPERTY OF EMERGENCY VEHICLES, INC. THEY ARE PROPRIETARY, AND ARE FOR THE EXCLUSIVE USE OF YOUR ENTITY. ANY DIVULGING OF THIS DATA TO A THIRD PARTY IS PROHIBITED.

*E. J. [Signature]* DATE: 01/29/08

REVISION 1	NS - 05/07/08
REVISION 2	NS - 08/21/08
REVISION 3	-
REVISION 4	-
REVISION 5	-

## Cambria County EMA Cambria County, Pennsylvania

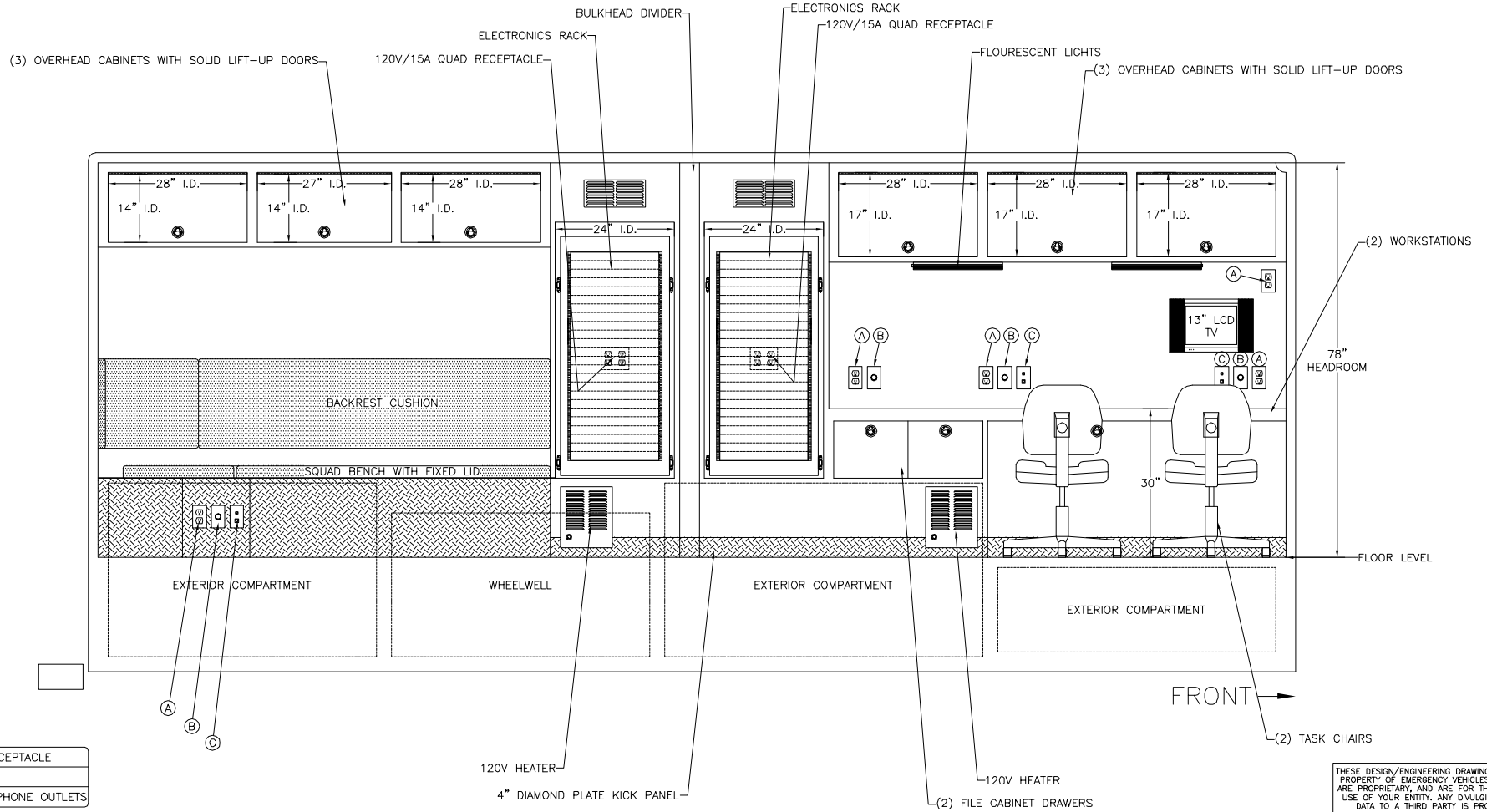

### Streetside Interior

THESE DESIGN/ENGINEERING DRAWING(S) ARE THE PROPERTY OF EMERGENCY VEHICLES, INC. THEY ARE PROPRIETARY, AND ARE FOR THE EXCLUSIVE USE OF YOUR ENTITY. ANY DULVING OF THIS DATA TO A THIRD PARTY IS PROHIBITED.

*E. J. ...* DATE: 01/29/08

REVISION 1	NS - 05/07/08
REVISION 2	NS - 08/21/08
REVISION 3	-
REVISION 4	-
REVISION 5	-

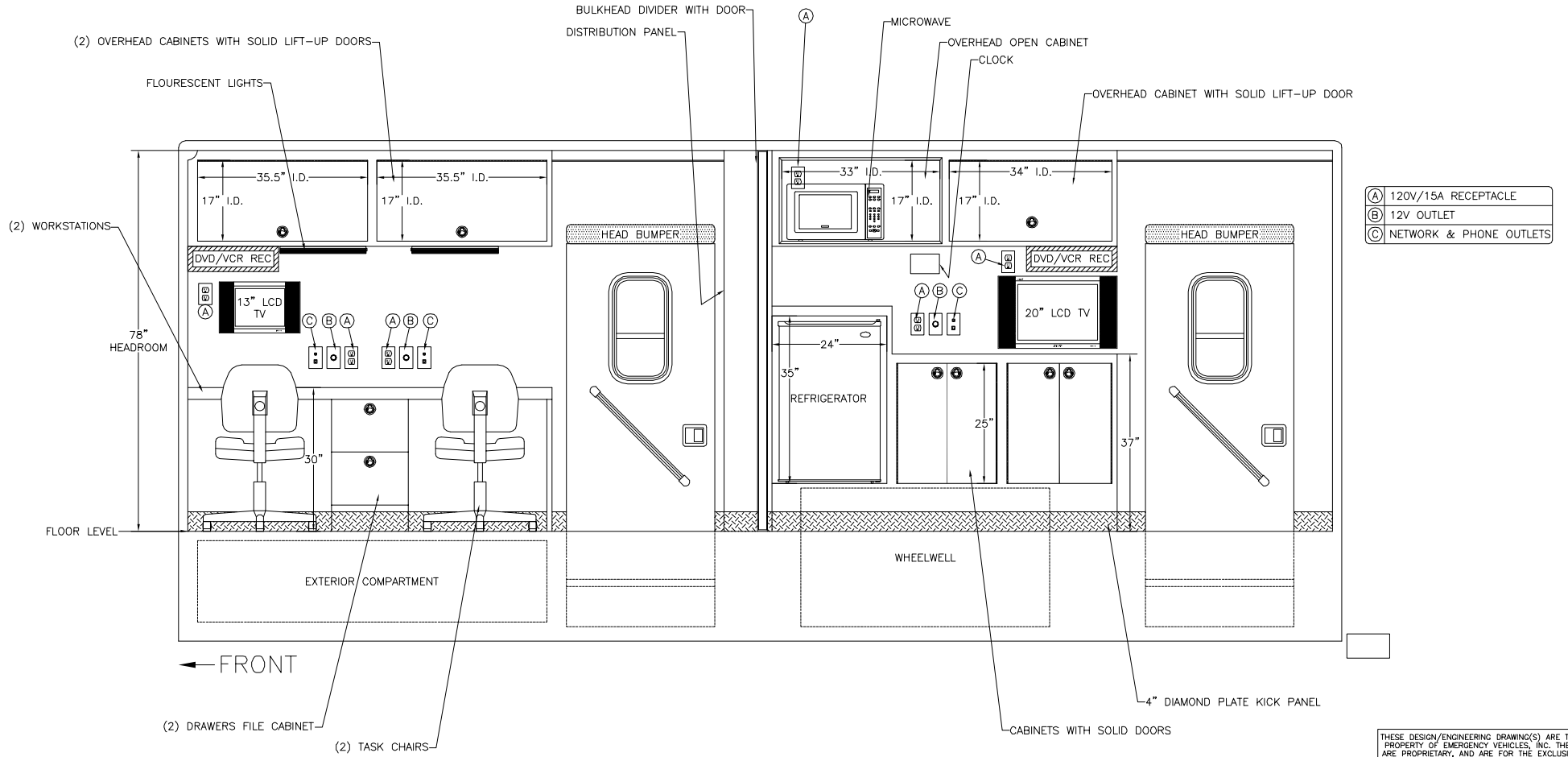

### Curbside Interior

THESE DESIGN/ENGINEERING DRAWING(S) ARE THE PROPERTY OF EMERGENCY VEHICLES, INC. THEY ARE PROPRIETARY, AND ARE FOR THE EXCLUSIVE USE OF YOUR ENTITY. ANY DNVOLGING OF THIS DATA TO A THIRD PARTY IS PROHIBITED.

*E. Vance* DATE: 01/29/08

REVISION 1	NS - 05/07/08
REVISION 2	NS - 08/21/08
REVISION 3	-
REVISION 4	-
REVISION 5	-



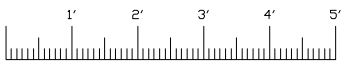
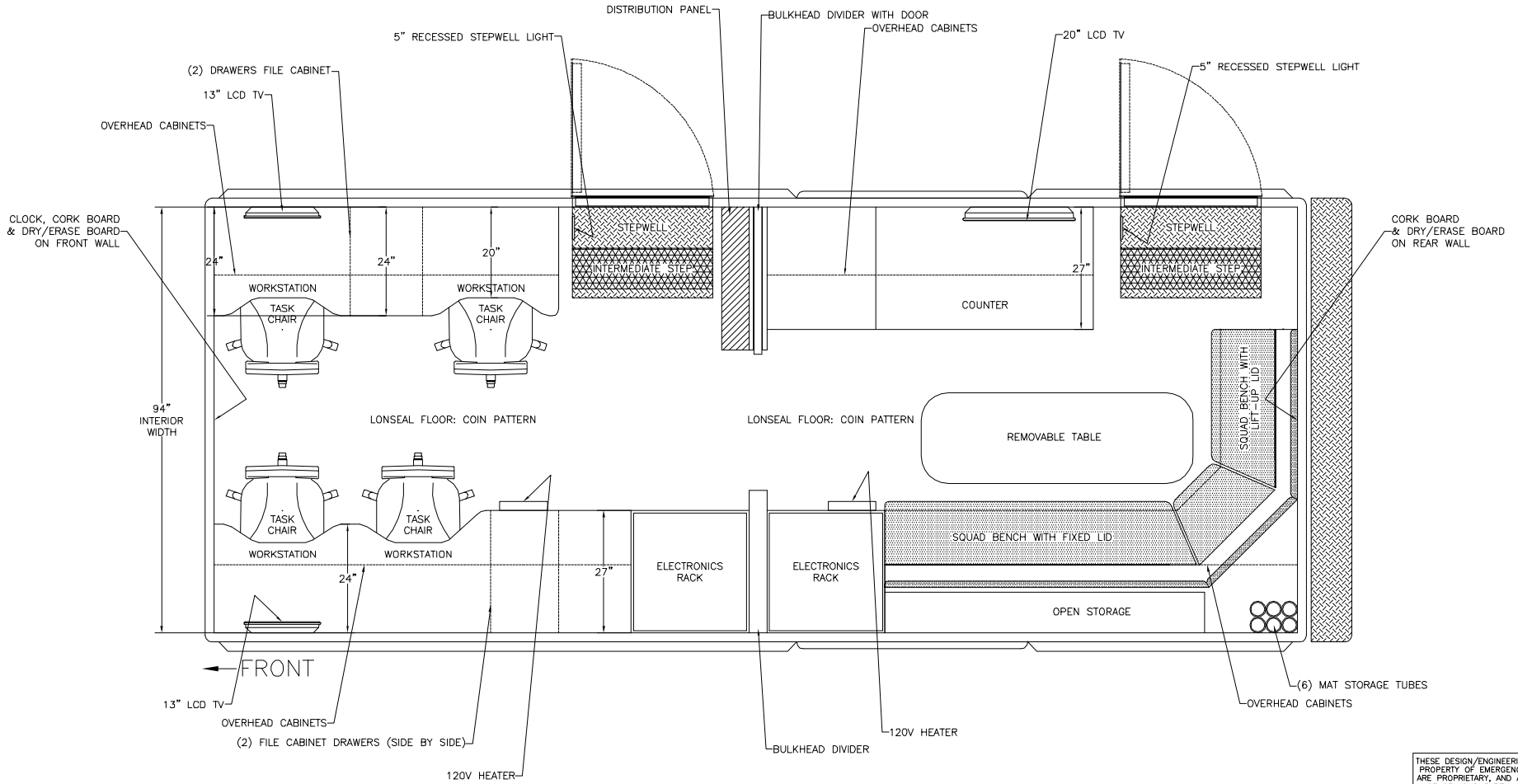

### Body Planview

THESE DESIGN/ENGINEERING DRAWING(S) ARE THE PROPERTY OF EMERGENCY VEHICLES, INC. THEY ARE PROPRIETARY, AND ARE FOR THE EXCLUSIVE USE OF YOUR ENTITY. ANY DIVULGING OF THIS DATA TO A THIRD PARTY IS PROHIBITED.

<i>E. Vance</i>		DATE: 01/29/08
REVISION 1	-	NS - 08/21/08
REVISION 2	-	
REVISION 3	-	
REVISION 4	-	
REVISION 5	-	

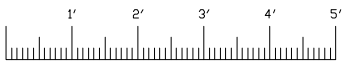
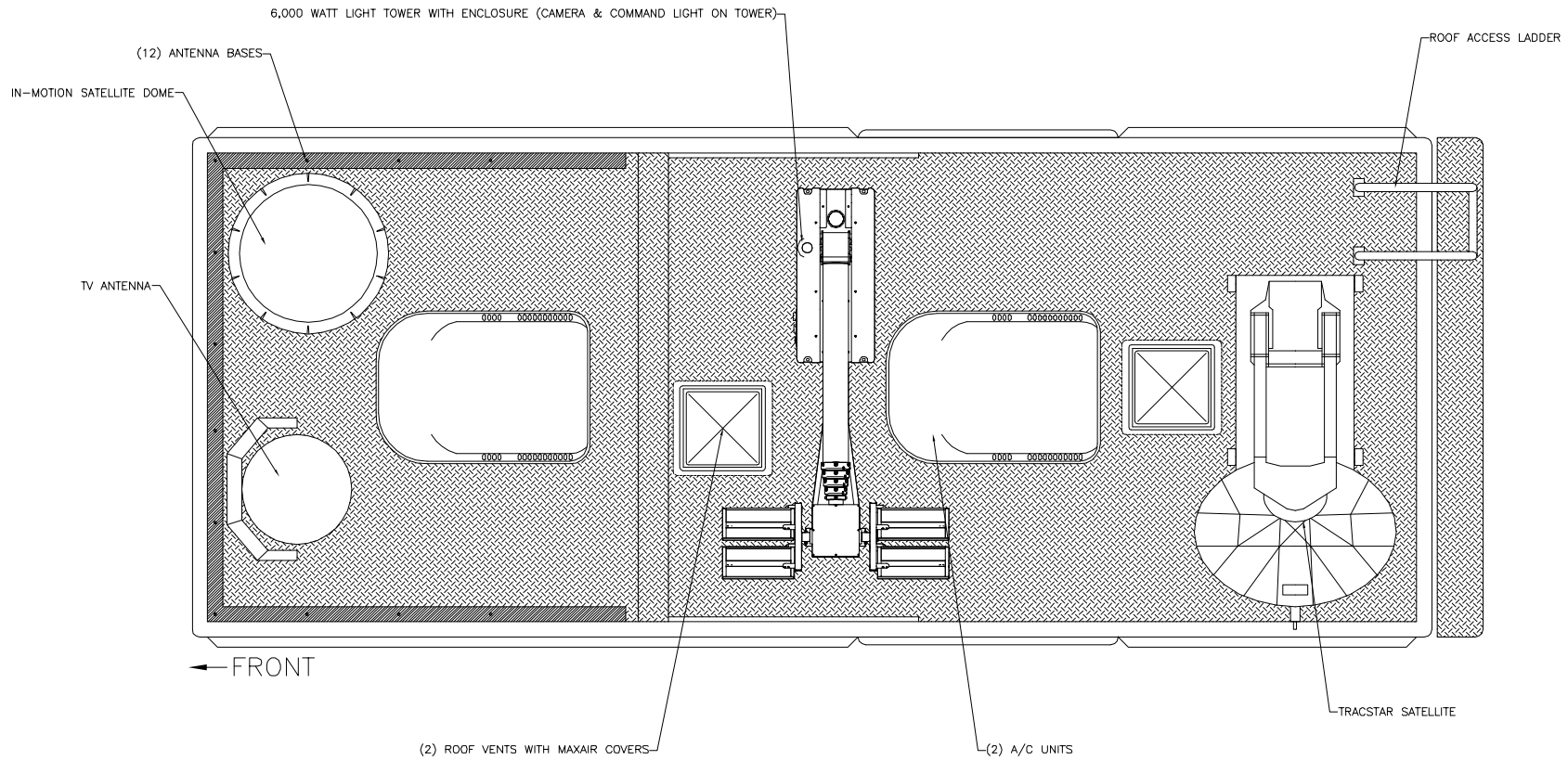

*Roof Planview*

THESE DESIGN/ENGINEERING DRAWING(S) ARE THE PROPERTY OF EMERGENCY VEHICLES, INC. THEY ARE PROPRIETARY, AND ARE FOR THE EXCLUSIVE USE OF YOUR ENTITY. ANY DIVULGING OF THIS DATA TO A THIRD PARTY IS PROHIBITED.

*E. J. Janner* DATE: 01/29/08

REVISION 1	NS - 08/21/08
REVISION 2	NS - 08/26/08
REVISION 3	-
REVISION 4	-
REVISION 5	-

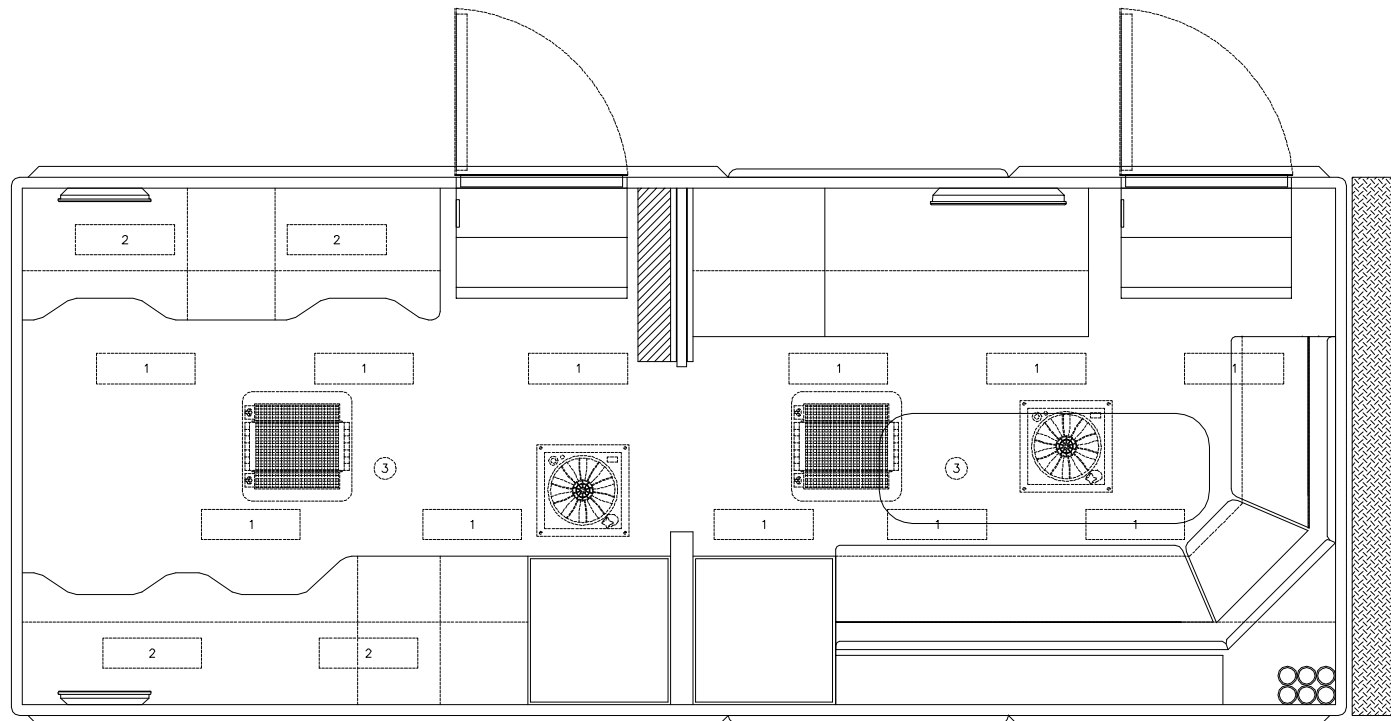

← FRONT

- CEILING LEGEND**  
 1 - 12V FLOURESCENT LIGHTS  
 2 - 12V FLOURESCENT LIGHTS - UNDERNEATH CABINETS  
 3 - RADIO SPEAKER

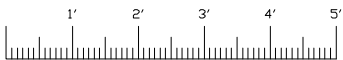

*Ceiling Planview*

THESE DESIGN/ENGINEERING DRAWING(S) ARE THE PROPERTY OF EMERGENCY VEHICLES, INC. THEY ARE PROPRIETARY, AND ARE FOR THE EXCLUSIVE USE OF YOUR ENTITY. ANY DNLGUNG OF THIS DATA TO A THIRD PARTY IS PROHIBITED.

		DATE: 01/29/08
REVISION 1	NS	08/21/08
REVISION 2	-	-
REVISION 3	-	-
REVISION 4	-	-
REVISION 5	-	-

FLEX SHAFT LT.

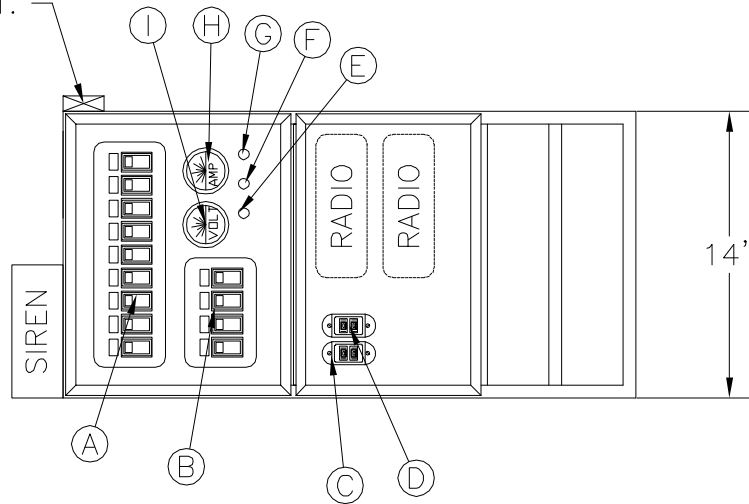

CONSTRUCTION: 1/2" PLYWOOD W/ MICA FINISH

- A – SWITCH BANK  
 1 – MASTER  
 2 – LOAD MANAGER  
 3 – WARNING LIGHTS – LED  
 4 – LIGHT BAR  
 5 – STINGER  
 6 – SPARE  
 7 – SPARE  
 8 – SPARE  
 9 – SPARE

- B – SWITCH BANK  
 1 – LEFT SCENE LIGHTS  
 2 – RIGHT SCENE LIGHTS  
 3 – REAR SCENE LIGHTS  
 4 – COMPT. LIGHTS/GRND. LIGHTS

- C – DOOR OPEN LIGHT  
 D – LEVEL SYSTEM LIGHT  
 E – LOW VOLT  
 F – MODULE POWER LIGHT  
 G – CHASSIS POWER LIGHT  
 H – AMMETER  
 I – VOLTMETER

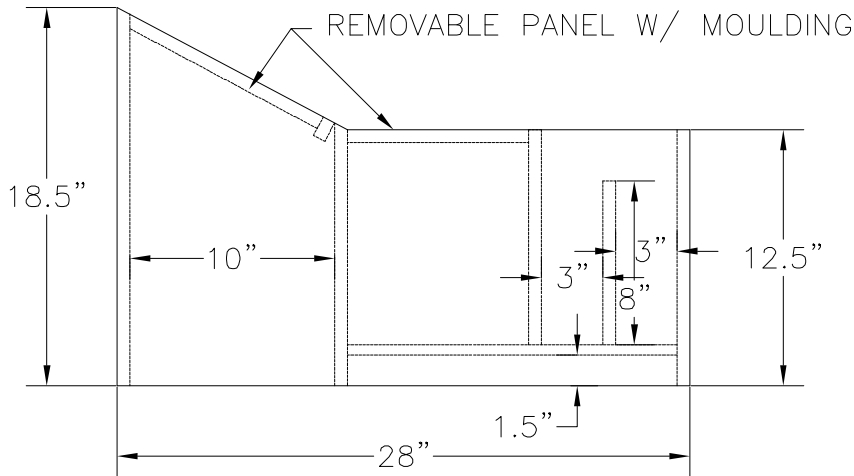

**EMERGENCY VEHICLES, INC.**

CAMBRIA COUNTY EMA  
 CAMBRIA COUNTY, PENNSYLVANIA

INTERNATIONAL 4400 CONSOLE

REVISIONS		
NO.	DATE	BY

SCALE

N.T.S.

APP'D

DRAWN BY

N.S.

DATE

05/07/08

DRAWING NO.  
 2766CON