

**REVISED:**

CHANGE ORDER REFERENCE:

COUNTY OF SAN DIEGO  
SAN DIEGO, CALIFORNIA

**STREETSIDE OVERALL**

REVISIONS	
1	NS-05/23/22
2	NS-10/24/22
3	NS-07/13/23
4	NS-02/09/23
5	NS-06/09/23 - PR
6	

SCALE: N.T.S.  
ALL DIMS IN INCHES

DRAWING NO.: RM3141

DRAWN BY: N.SUAREZ

DATE: 06/08/23

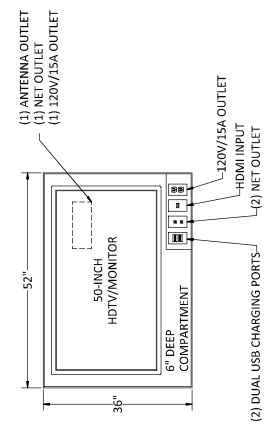
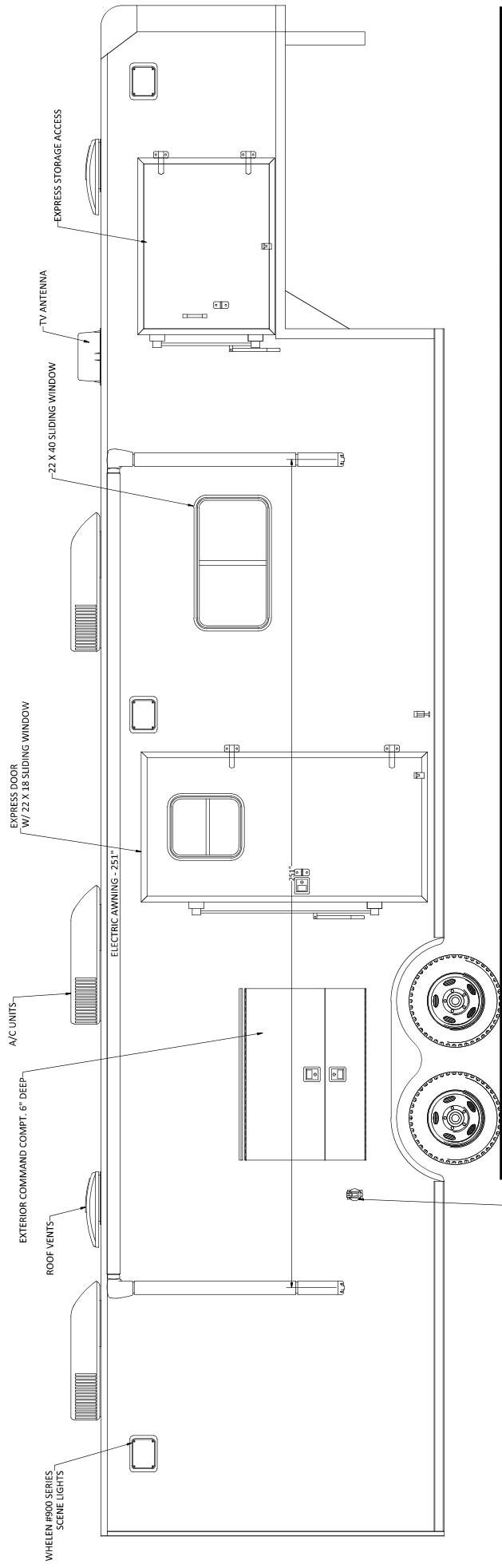

**REVISED:**

CHANGE ORDER REFERENCE:

COUNTY OF SAN DIEGO  
SAN DIEGO, CALIFORNIA

**CURBSIDE OVERALL**

REVISIONS	SCALE	DRAWN BY
1. NS-06/23/23	N.T.S.	N. SUAREZ
2. NS-10/24/22	ALL DIMS IN INCHES	DATE
3. NS-01/13/23	DRAWING NO.	06/08/23
4. NS-02/03/23	RM3141	
5. NS-06/08/23 - PR		
6.		

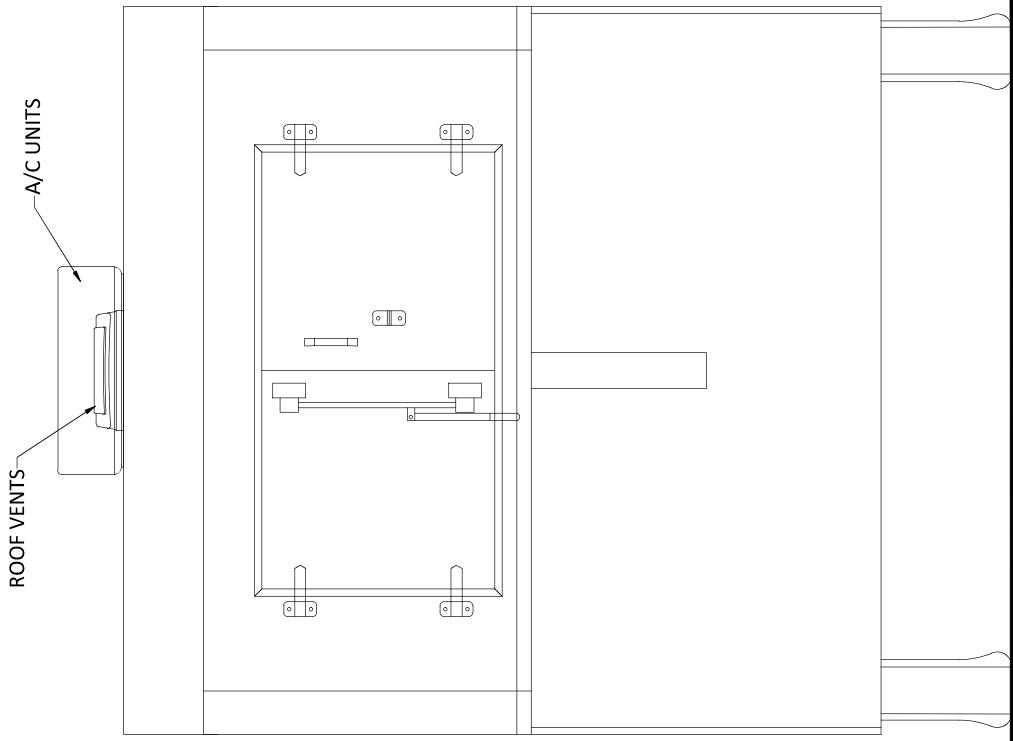

**REVISED:**

CHANGE ORDER REFERENCE:

COUNTY OF SAN DIEGO  
SAN DIEGO, CALIFORNIA

**FRONT VIEW**

**REVISIONS**

1	NS-06/23/23
2	NS-10/24/22
3	NS-11/22/22
4	NS-01/19/23
5	NS-02/09/23
6	NS-06/08/23 - PR

SCALE  
N.T.S.  
ALL DIMS IN INCHES

DRAWING NO.  
RM3141

DRAWN BY  
N. SUAREZ

DATE  
06/08/23

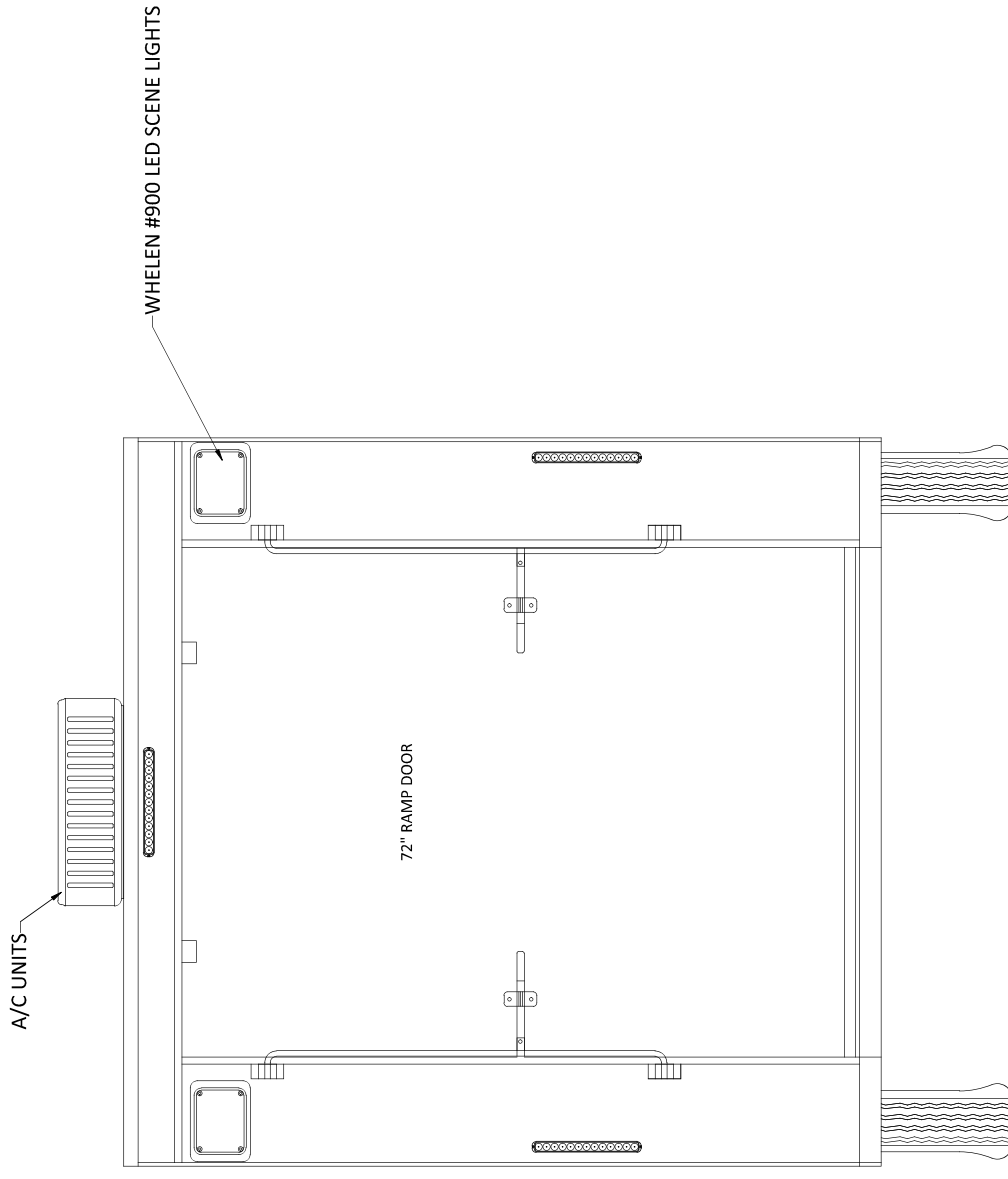

REVISED: 08/02/23

COUNTY OF SAN DIEGO  
SAN DIEGO, CALIFORNIA

REVISIONS

1	NS-05/23/22
2	NS-10/24/22
3	NS-01/23/23
4	NS-02/03/23
5	NS-06/08/23 - PR
6	NS-08/02/23-COI

SCALE  
N.T.S.  
ALL DIMS IN INCHES

DRAWING NO.  
RM3141

DRAWN BY  
N.SUAREZ

DATE  
06/08/23

CHANGE ORDER REFERENCE: